

*DAMAC*



CANAL  
HEIGHTS

de GRISOGONO

A CENTURIES-OLD TREASURE TRANSFORMED.

A circular inset on the right side of the page shows a blurred floor plan. The text "FLOOR PLANS" is centered over this inset.

FLOOR PLANS

# STUDIO

TYPE D1



LEVEL 02

# STUDIO

TYPE D1-M



LEVEL 02

# 1-BEDROOM

TYPE A1

# 1-BEDROOM

TYPE A1-M

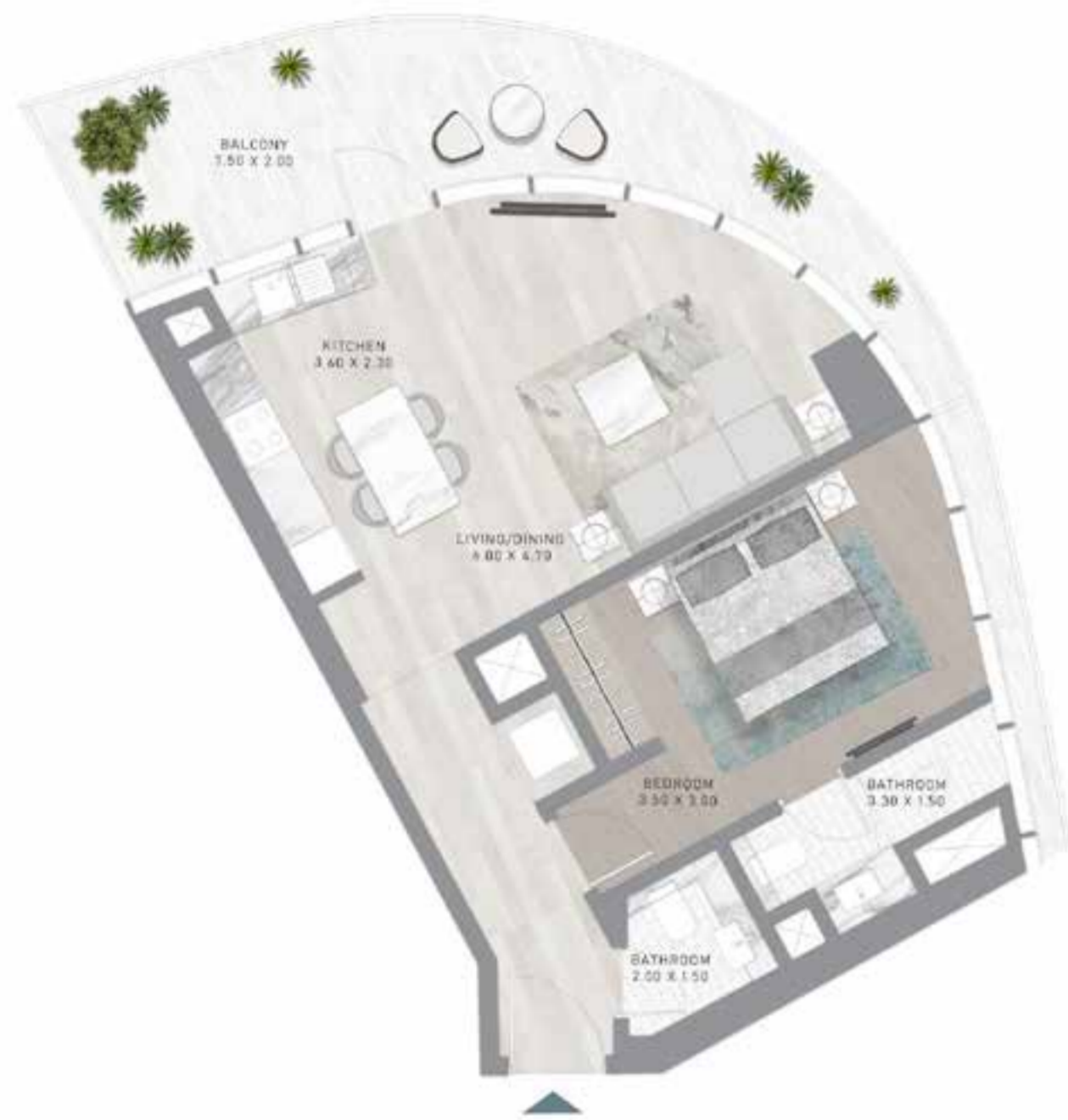

LEVEL 02



LEVEL 02

# 1-BEDROOM

TYPE B1



LEVEL 21

# 1-BEDROOM

TYPE B1-M



LEVEL 21

# 1-BEDROOM

TYPE D1



LEVEL 21

# 1-BEDROOM

TYPE D1-M



LEVEL 21

# 1-BEDROOM

TYPE E1



LEVEL 27

# 1-BEDROOM

TYPE E1-M



LEVEL 27



# 1-BEDROOM

TYPE G1



LEVEL 32

# 1-BEDROOM

TYPE G1-M



LEVEL 32

# 1-BEDROOM

TYPE H1



LEVEL 32

# 1-BEDROOM

TYPE H1-M



LEVEL 32

# 2-BEDROOM

TYPE A1



LEVEL 02

# 2-BEDROOM

TYPE A1-M



LEVEL 02

# 2-BEDROOM

TYPE B1



LEVEL 21

# 2-BEDROOM

TYPE B1-M



LEVEL 21

# 2-BEDROOM

TYPE C1



LEVEL 27

# 2-BEDROOM

TYPE C1-M



LEVEL 27

# 2-BEDROOM

TYPE D1

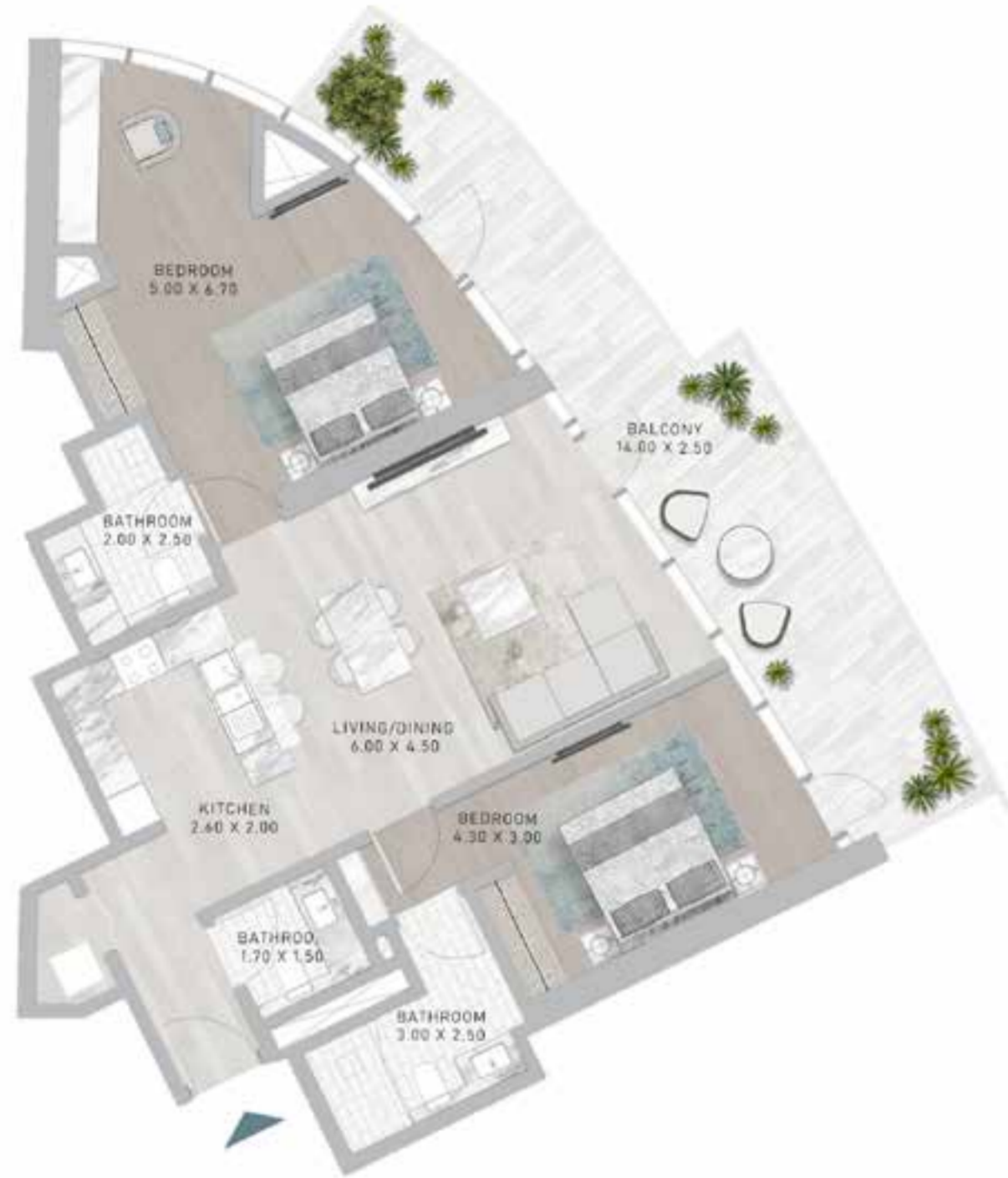

LEVEL 32

# 2-BEDROOM

TYPE D1-M



LEVEL 32



**TANAMI**  
P R O P E R T I E S

## CONTACT US

 +971 4 248 3400 |  +971 55 162 3236

### Email Us

info@tanamiproperties.ae

### For More Info...

[www.tanamiproperties.com/Projects/Damac-Canal-Heights](http://www.tanamiproperties.com/Projects/Damac-Canal-Heights)



### ADDRESS

Office 3405, Marina Plaza,  
Al Marsa Street, Dubai Marina, UAE

*DAMAC*